

# PUBLIC NOTICE

## CUREPE INTERCHANGE PROJECT

# TEMPORARY TRAFFIC DISRUPTION

**Temporary Closure of the Churchill Roosevelt Highway in the vicinity of the Curepe Interchange from Sunday 1st March, 2020 at 6:00 AM to Monday 2nd March, 2020 at 3:00 AM**

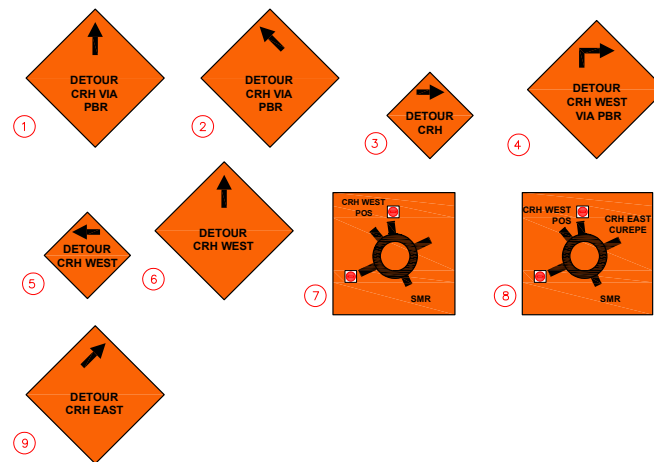
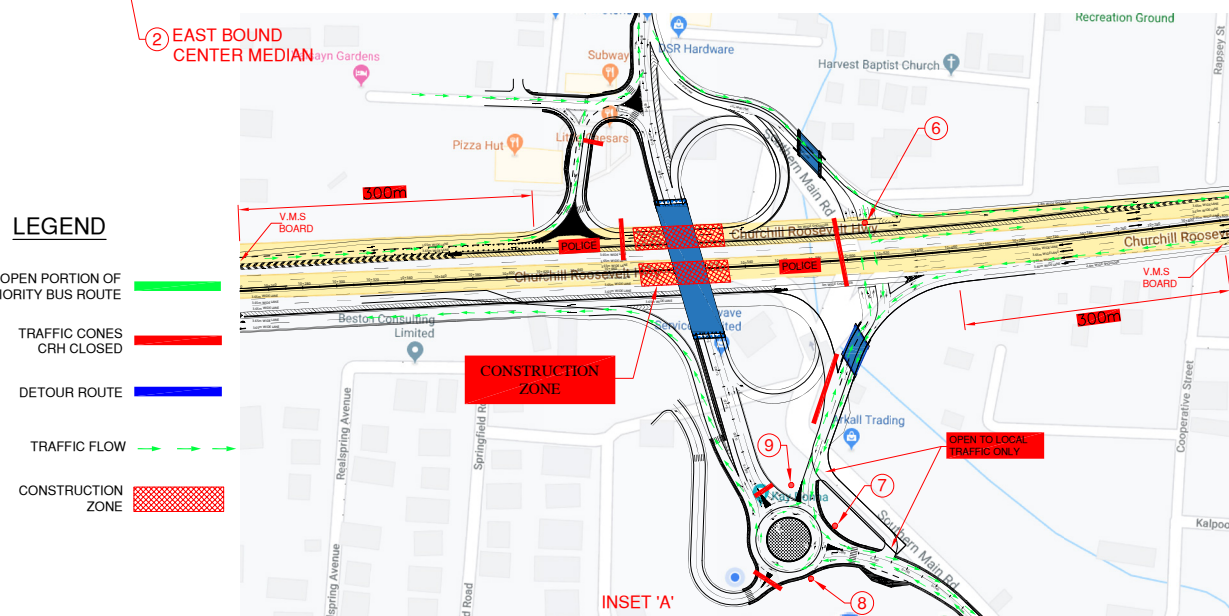
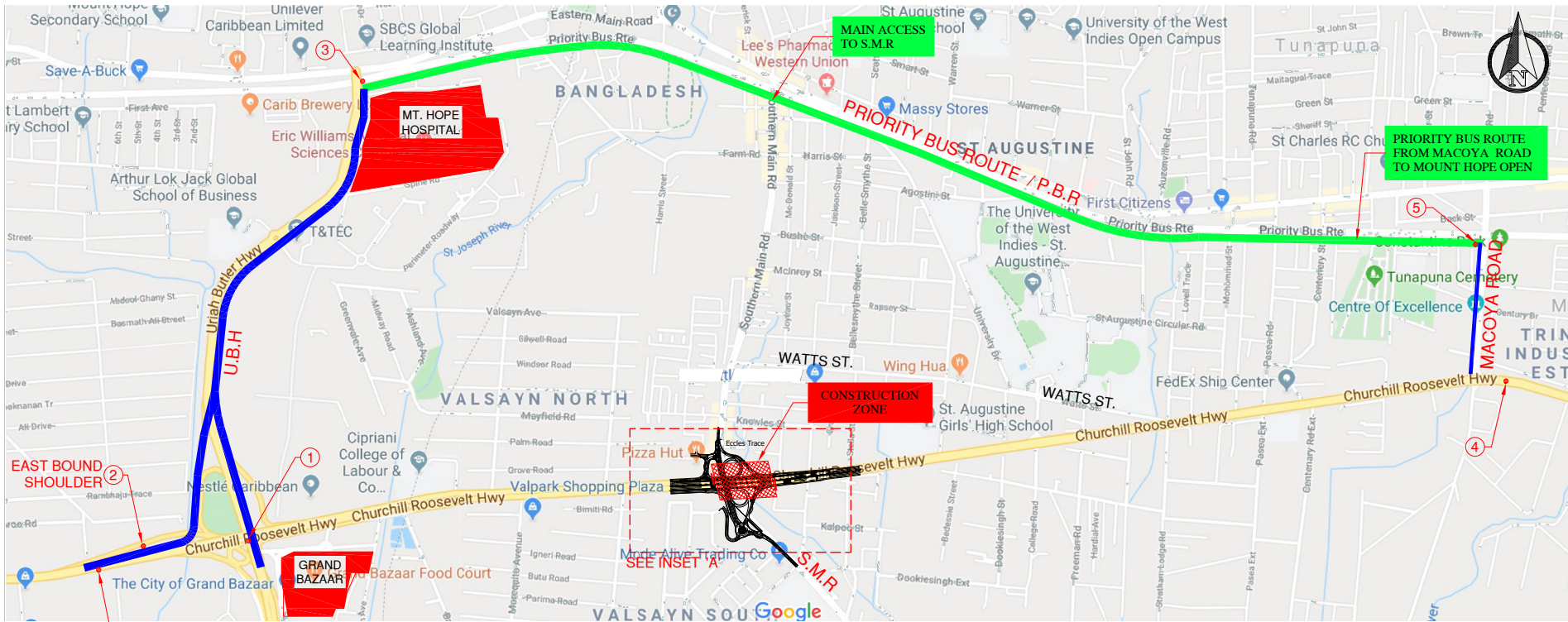

(Continued on page 2.)

# PUBLIC NOTICE

## CUREPE INTERCHANGE PROJECT

# TEMPORARY TRAFFIC DISRUPTION

The National Infrastructure Development Company Limited (NIDCO) in partnership with the Ministry of Works and Transport (MOWT) wishes to advise the general public (motorists/residents/pedestrians) that:

- there will be a temporary closure of a section of the Churchill Roosevelt Highway (CRH) in the vicinity of the Curepe Interchange commencing on Sunday 1st March, 2020 at 6:00 AM and ending on Monday 2nd March, 2020 at 3:00 AM to facilitate the removal of formwork from the Bridge Deck; and
- there will also be intermittent traffic disruption(s) along the westbound and eastbound lane(s) of the CRH from Morequito Avenue (in the vicinity of Valpark) to the Spring Village Hindu School to facilitate the Installation of Overhead Gantry Signs Structures. During this time all traffic will be diverted accordingly by police officers on site.

Motorists are advised that the following **detours** will be in effect:

### **ALTERNATIVE ROUTES**

During this period **ONLY** the Priority Bus Route will be open from its intersections with the Uriah Butler Highway (Mt. Hope Intersection) to the Macoya Road Intersection.

### **ACCESS TO AREAS EAST OF THE CLOSED SECTION OF THE CRH**

#### **• FROM UBH NORTHBOUND**

Motorists travelling north along the Uriah Butler Highway (UBH) from San Fernando, Chaguanas and environs who wish to proceed East beyond the closed section of the CRH are advised to continue along the northbound section of the UBH and turn right onto the Priority Bus Route (PBR) at the Mt. Hope Intersection. Motorists should then proceed along the authorized section of the PBR and turn right at its intersection with Macoya Road to access the CRH.

#### **• FROM CRH EASTBOUND**

Motorists travelling east along the Churchill Roosevelt Highway (CRH) from Port of Spain, El Socorro and environs who wish to proceed East beyond the closed section of the CRH will be diverted to the northbound section of the Uriah Butler Highway and should turn right onto the Priority Bus Route (PBR) at the Mt. Hope Intersection. Motorists should then proceed along the authorized section of the PBR and turn right at its intersection with Macoya Road to access the CRH.

*(Continued on page 3.)*

# PUBLIC NOTICE

## CUREPE INTERCHANGE PROJECT

# TEMPORARY TRAFFIC DISRUPTION

### ACCESS TO AREAS WEST OF THE CLOSED SECTION OF THE CRH

#### • FROM CRH WESTBOUND

Motorists travelling west along the Churchill Roosevelt Highway (CRH) from Arima, Piarco, Trincity and environs who wish to proceed West beyond the closed section of the CRH will be diverted to Macoya Road (North) and should then turn left onto the Priority Bus Route (PBR). Motorists should then proceed along the authorized section of the PBR, turn left at the Mt. Hope Intersection to access the UBH Southbound and follow the directional signs to access the CRH.

#### • FROM SMR NORTH

Motorists travelling south along Southern Main Road from Curepe and environs who wish to proceed West along the Churchill Roosevelt Highway (CRH) are advised that there are no major changes to existing movements. Motorists are advised to proceed south, at the signalized intersection, across the CRH and observe all temporary directional signage provided on the approaches to the site to access the CRH Westbound. All other movements remain the same.

#### • FROM SMR SOUTH

Motorists travelling north along Southern Main Road from Caroni, Spring Village and environs who wish to proceed to the Churchill Roosevelt Highway or Southern Main Road (North) to Curepe and environs are advised that there are no major changes to existing movements. Motorists are further advised to observe all temporary directional signage provided on the approaches to the site to access their final destination.

#### • LOCAL TRAFFIC

Motorists and residents whose final destination lies within the temporarily closed section of the Churchill Roosevelt Highway (Valsayn North, Valsayn South, Bamboo No. 2, Bamboo No. 3 and environs) will be diverted accordingly or allowed to proceed to access their final destination.

#### **Motorists are also advised to comply with following:**

- proceed with caution and drive at a reduced speed on approaching the work zone
- observe all temporary directional signage provided on the approaches to the site
- instructions issued by police officers on site to facilitate a safe and orderly flow of traffic
- be aware of heavy equipment entering and exiting the site

All precautions are being taken by the MOWT, NIDCO and its Contractor to guarantee proper Health, Safety and Environmental Standards are maintained.

*We thank you for your continued cooperation and regret any inconvenience caused.*